

Strainers

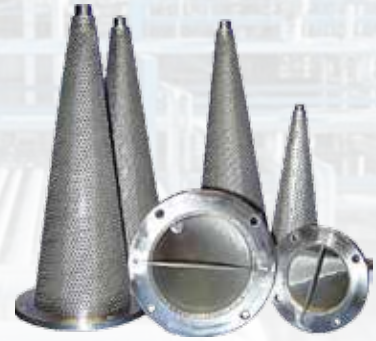

EXCELOK TECHNOLOGIES PTE LTD
Singapore

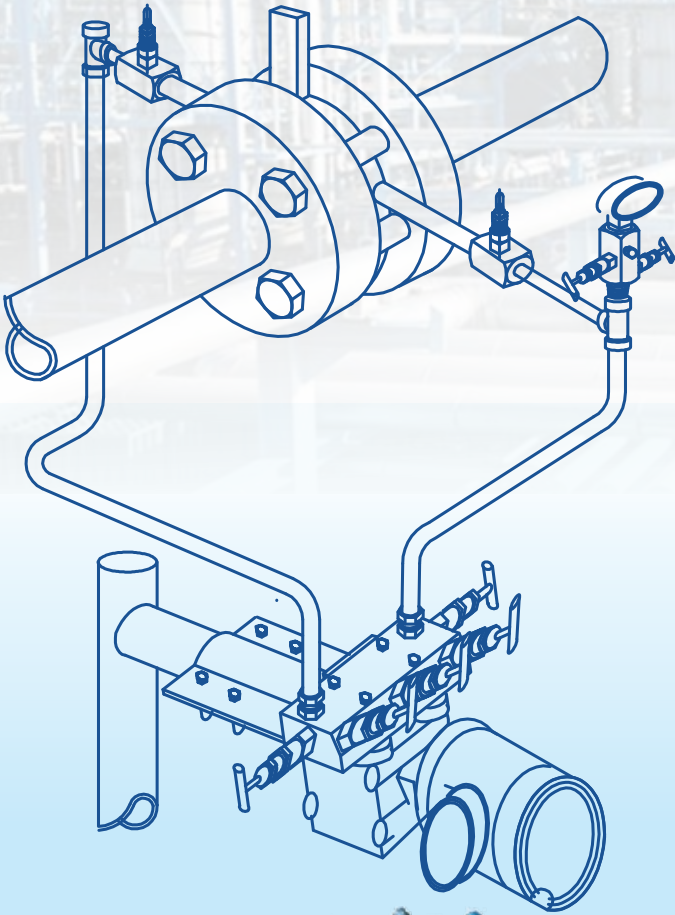

Our Strainers

All types of Strainers are available, Sizes range from 1" – 24". Body materials include Cast Iron, Cast Steel, Stainless Steel, Alloy 20, GRP/FRP and Bronze. Exotic material such as Monel, Hastelloy, Super Duplex Stainless and Titanium or special coating is also available for those challenging applications. Pressure classes start at ANSI 125# and go up to ANSI 2500# in threaded, flanged or socket weld end connections, higher pressure classes and other end connections are also available.



Y-Strainers

- The Y-Strainer are equipped with a blow off port.
- A ball valve can be fitted to flush debris that is easily removable from the screen and exhaust to atmosphere or a drain system. This feature allows for easy cleaning without interrupting the process.

Basket Strainers

- Basket Strainers can be equipped with Bolted Covers, Hinged Covers Clamped Covers, a Davit Lifting Device or other Lifting Device to make removal of large heavy covers safe and efficient.
- Widespread list of options are available

Tee Strainers

- Tee strainers are most commonly supplied with a range of graded filtration levels (fine to coarse or viceversa) to ensure that the system is running at the required cleanliness level when met with full load.
- Tee strainers feature either bolted cover or quick opening covers for application suitability.
- They can be mounted into vertical or horizontal piping and can be configured for right- angled applications

Conical Strainers / Temporary Strainers

- Basket, Cone, Plate, Reverse Flow and many different engineering designs are available.
- Standard Size and Pressure Rating is Stamped on Handle.
- We specialize in supplying standard replacement strainer screens and baskets as well as custom engineered designs or competitor units..



BI25 and BI50 Dimensional Data

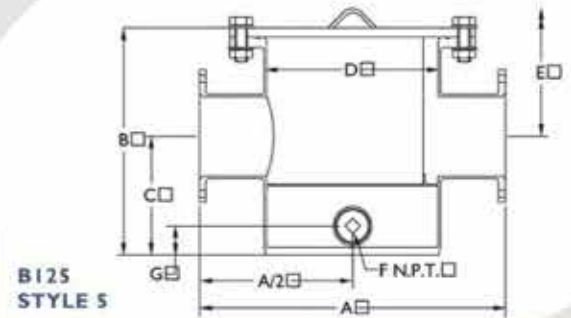
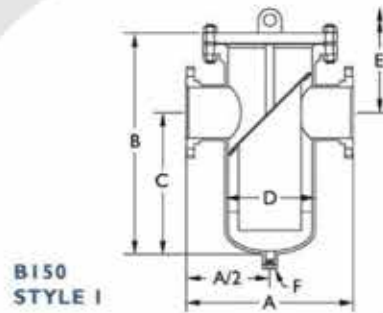

Standard Screens

Size Range	Opening	Size Range	Opening
2" - 8" (50mm - 200mm)	0.125 in. (3.2mm)	3" - 10" (80mm - 250mm)	0.25 in. (6.4mm)
10" - 12" (250mm - 300mm)	0.125 in. (3.2mm)		
14" - 24" (250mm - 600mm)	0.188 in. (4.8mm)		

Dimensional Data

Size in. (mm)	A in. (mm)		B in. (mm)		C in. (mm)		D in. (mm)		E in. (mm)		F in. (mm)		G in. (mm)		Weight Lb. (kg.) Cover Unit			
	I	S	I	S	I	S	I	S	I	S	I	S	S	I	S	I	S	
2" 50	12.75 324	-	18.63 473	-	11.13 283	-	6.63 168	-	25.00 635	-	1/2 15	-	-	26 12	-	85 39	-	
3" 80	14.00 356	14.13 359	20.50 521	18.44 468	12.50 318	10.63 270	8.63 219	8.63 219	28.50 724	26.25 667	3/4 20	2 50	2.13 54	45 20	28 13	140 63	107 48	
4" 100	16.00 406	21.00 533	22.25 565	18.44 468	14.00 356	10.63 270	8.63 219	8.63 219	30.50 775	26.25 667	1 25	2 50	2.13 54	45 20	28 13	145 66	142 64	
5" 125	18.00 457	-	24.25 616	-	17.00 432	-	10.75 273	-	30.50 775	-	1 25	-	-	70 32	-	160 72	-	
6" 150	20.00 508	26.88 683	26.50 673	20.19 513	17.00 432	11.06 281	10.75 273	14.00 356	36.00 914	29.32 745	1 25	3 80	3.00 76	70 32	64 29	205 93	303 137	
8" 200	22.00 559	31.25 794	32.00 813	22.88 581	21.00 533	12.06 306	12.75 324	18.00 457	43.00 1092	33.70 856	1 1/2 40	3 80	3.00 76	110 50	143 65	420 190	398 180	
10" 250	32.00 813	30.00 762	41.50 1054	27.13 689	25.00 635	14.81 376	16.00 406	20.00 508	58.00 1473	39.45 1002	1 1/2 40	3 80	3.25 83	180 82	184 83	650 294	463 210	
12" 300	35.00 889	-	44.75 1137	-	28.00 711	-	18.00 457	-	61.50 1562	-	1 1/2 40	-	-	220 100	-	1205 546	-	
14" 350	37.00 940	-	48.75 1238	-	33.00 838	-	20.00 508	-	64.50 1638	-	2 50	-	-	285 129	-	1600 725	-	
16" 400	42.00 1067	-	54.25 1378	-	36.00 914	-	24.00 610	-	72.50 1842	-	2 50	-	-	430 195	-	1965 890	-	
18" 450	46.50 1181	-	60.00 1524	-	40.00 1016	-	24.00 610	-	80.00 2032	-	2 50	-	-	430 195	-	2200 997	-	
20" 500	52.00 1321	-	68.00 1727	-	46.00 1168	-	30.00 762	-	90.00 2286	-	2 50	-	-	965 437	-	3200 1450	-	
24" 600	64.00 1626	-	82.75 2102	-	55.00 1397	-	36.00 914	-	110.50 2807	-	2 50	-	-	1540 698	-	4500 2039	-	

Notes: I. Dimensions shown are subject to change.



EXCELOK TECHNOLOGIES PTE LTD

No. 21, Bukit Batok Crescent #15-82 WCEGA Tower, Singapore-658 065.

Tel:+65-65671577 | sales@excelok.com.sg, www.excelok.com.sg



B300 Dimensional Data

Standard Screens

Size Range	Opening	Gauge Thickness
2" - 8" (50mm - 200mm)	0.125 in. (3.2mm)	22
10" - 12" (250mm - 300mm)	0.125 in. (3.2mm)	16
14" - 16" (350mm - 400mm)	0.188 in. (4.8mm)	11

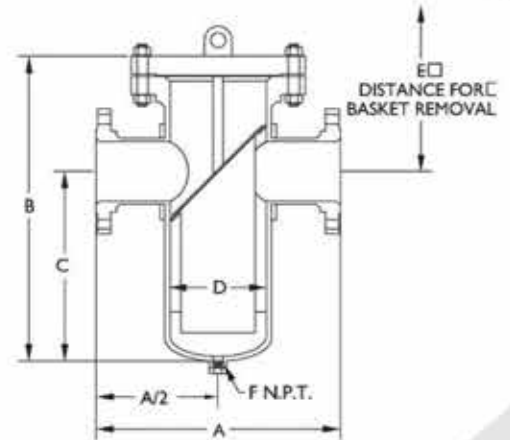

Dimensional Data (Classes 125, 250)

Size in. (mm)	A in. (mm)	B in. (mm)	C in. (mm)	D in. (mm)	E in. (mm)	F in. (mm)	Weight Lb. (kg)	Unit
2"	14.88	20.00	12.00	6.63	28.00	1/2	50	195
50	378	508	305	168	711	15	23	89
3"	16.50	25.00	15.75	8.63	34.25	3/4	81	250
80	419	635	400	219	870	20	37	114
4"	18.63	26.00	15.88	8.63	36.13	1	81	300
100	473	660	403	219	918	25	37	136
5"	20.25	28.00	17.13	10.75	38.88	1	125	400
125	514	711	435	273	987	25	57	182
6"	24.50	30.75	19.13	10.75	42.38	1	125	480
150	622	781	486	273	1076	25	57	218
8"	24.88	35.50	22.00	12.75	55.75	1 1/2	185	681
200	632	902	559	324	1416	40	84	310
10"	35.38	42.50	27.25	16.00	57.25	1 1/2	295	1100
250	899	1080	692	406	1454	40	134	500
12"	39.38	47.75	30.38	18.00	65.12	1 1/2	395	1650
300	1000	1213	772	457	1654	40	179	750
14"	41.50	52.50	33.00	20.00	72.00	2	505	2600
350	1054	1334	838	508	1829	50	229	1182
16"	47.50	60.00	38.88	24.00	81.13	2	790	2750
400	1207	1524	988	610	2061	50	358	1250

Notes: 1. Dimensions shown are subject to change.



EXCELOK TECHNOLOGIES PTE LTD

No. 21, Bukit Batok Crescent #15-82 WCEGA Tower, Singapore-658 065.
Tel:+65-65671577 | sales@excelok.com.sg, www.excelok.com.sg



B600 Dimensional Data

Standard Screens

Size Range	Opening	Gauge Thickness
2" - 8" (50mm - 200mm)	0.125 in. (3.2mm)	22
10" - 12" (250mm - 300mm)	0.125 in. (3.2mm)	16
14" - 16" (350mm - 400mm)	0.188 in. (4.8mm)	11

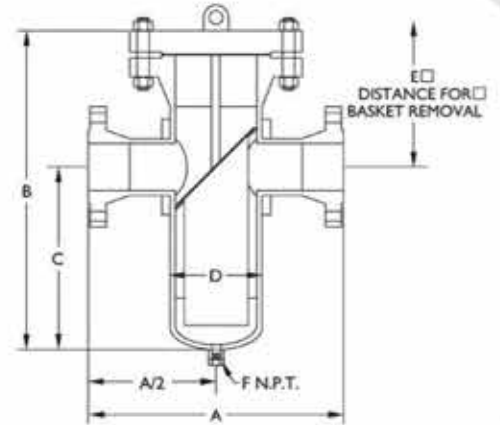

Dimensional Data

Size in. (mm)	A in. (mm)	B in. (mm)	C in. (mm)	D in. (mm)	E in. (mm)	F in. (mm)	Weight Lb. (kg.) Cover	Unit
2" (50)	18.38 (467)	21.88 (556)	12.00 (305)	6.63 (168)	31.75 (806)	1/2 (15)	86 (39)	245 (111)
3" (80)	23.88 (606)	26.50 (673)	15.75 (400)	8.63 (219)	37.25 (946)	3/4 (20)	140 (64)	360 (164)
4" (100)	23.88 (606)	29.00 (737)	17.38 (441)	8.63 (219)	44.63 (1133)	1 (25)	140 (64)	400 (182)
5" (125)	28.13 (714)	32.13 (816)	19.13 (486)	10.75 (273)	45.13 (1146)	1 (25)	230 (105)	750 (341)
6" (150)	29.88 (759)	36.25 (921)	21.38 (543)	10.75 (273)	51.13 (1299)	1 (25)	230 (105)	825 (375)
8" (200)	37.00 (940)	38.75 (984)	23.38 (594)	12.75 (324)	54.13 (1375)	1 1/2 (40)	295 (134)	1200 (545)
10" (250)	42.50 (1080)	47.25 (1200)	27.25 (692)	16.00 (406)	68.25 (1708)	1 1/2 (40)	495 (225)	1600 (727)
12" (300)	44.00 (1118)	53.25 (1353)	30.38 (772)	18.00 (457)	76.13 (1934)	1 1/2 (40)	630 (286)	1800 (818)
14" (350)	46.00 (1168)	60.00 (1524)	35.13 (892)	20.00 (508)	84.88 (2156)	2 (50)	810 (367)	3000 (1364)
16" (400)	54.00 (1372)	70.00 (1778)	42.25 (1073)	24.00 (610)	97.75 (2483)	2 (50)	1250 (567)	3200 (1455)

Notes: 1. Dimensions shown are subject to change.



EXCELOK TECHNOLOGIES PTE LTD

No. 21, Bukit Batok Crescent #15-82 WCEGA Tower, Singapore-658 065.
Tel:+65-65671577 | sales@excelok.com.sg, www.excelok.com.sg



Y125 and Y150 Fabricated Y-Strainers

Design Features

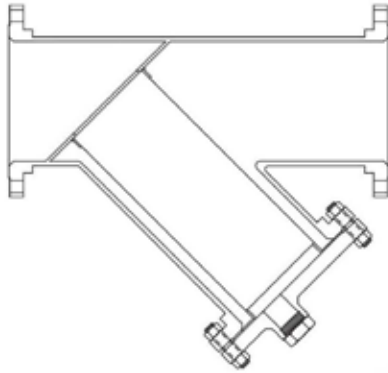

- Standard sizes from 2" - 24".
- Available with RF or RTJ flanged (ASME B16.5), Buttweld (ASME B16.9) or grooved end connections.
- Standard thru bolt or grooved cover design.
- Custom modifications are available.
- May be installed in horizontal or vertical pipelines.
- All welders are qualified to ASME Section IX.
- Strainers designed to meet the requirements of ASME B31.1 and/or ASME B31.3.
- 304 SS perforated screens are standard.
- Drains connections are standard and are furnished with plug.
- Vents, differentials and special covers are optional.

Parts list & Standard Materials (Flanged End)

Part	Carbon Steel	Stainless Steel ¹
Shell & Nozzles	A53 E/B / A106-B	A312
Reinforcement Pads ²	A516-70	A240
Flanges	A105	A182
Coupling/threadolet:	A105	A182
Plug	A105	A182
Screen Retainer Ring	A36	A240
Screen ³	304 SS	304 SS
Gasket ³	304 SS Spiral Wound	304 SS Spiral Wound
Stud	A193-B7	A193-B8-1
Nut	A194-2H	A194-8

Notes: ¹ Recommended Spares.

Parts list & Standard Materials (Grooved End)

Part	Stainless Steel
Shell & Nozzles	A312-304
Flanges	A36 Zinc Plated
Plug	B584 Brass
Cover	Sizes 2 1/2" - 5" & 12": Ductile Iron Sizes 6" - 10": 304 SS
Screen ¹	304 SS
Gasket ¹	EPDM
Bolts	B633
Nuts	B633

Notes: ¹ Recommended Spares.

Upper Pressure Limits (non-shock) and Lower Temperature Limits (unless otherwise specified)

Class	Body Material	Size Range in. (mm)	Maximum Design Pressure psig (Bars) ¹	Low Temperature Limit – M.D.M.T. – °F (°C)
Y125FSBW	Carbon Steel	2" - 12" (50mm - 300mm)	200 (13.79) ²	-20 (-28.9)
		14" - 24" (350mm - 600mm)	150 (10.34) ²	-20 (-28.9)
Y125GSS4GW	304 SS	2 1/2" - 12" (65mm - 300mm)	200 (13.79) ²	-20 (-28.9)
Y125FSS4BW / Y125FSS6BW	304 / 316 SS	2" - 12" (50mm - 300mm)	200 (13.79) ²	-20 (-28.9)
		14" - 24" (350mm - 600mm)	150 (10.34) ²	-20 (-28.9)
Y125FSS4LBW / Y125FSS6LBW	304L / 316L SS	2" - 12" (50mm - 300mm)	200 (13.79) ²	-20 (-28.9)
		14" - 24" (350mm - 600mm)	150 (10.34) ²	-20 (-28.9)
Y150FSBW	Carbon Steel	2" - 12" (50mm - 300mm)	285 (19.65) ³	-20 (-28.9)
Y150FSS4BW / Y150FSS6BW	304 / 316 SS	2" - 12" (50mm - 300mm)	275 (18.96) ³	-20 (-28.9)



EXCELOK TECHNOLOGIES PTE LTD

No. 21, Bukit Batok Crescent #15-82 WCEGA Tower, Singapore-658 065.
Tel:+65-65671577 | sales@excelok.com.sg, www.excelok.com.sg



YI25, YI50 and YI25GSS4GW Dimensions

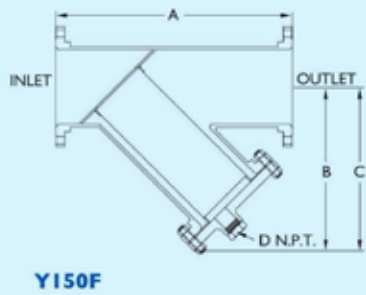

YI50F

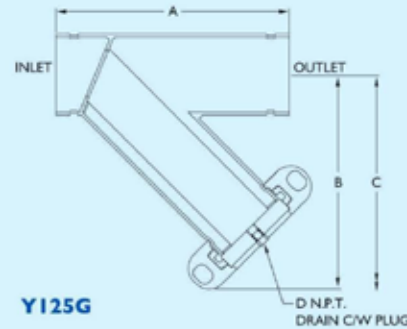

YI25G

Standard Screens

Flanged End		Grooved End	
Size Range	Opening	Size range	Opening
2" - 8" (50mm - 200mm)	0.125 in. (3.2mm)	2.5" - 5" (65mm - 125mm)	0.063 in. (1.5mm)
10" - 12" (250mm - 300mm)	0.125 in. (3.2mm)	6" - 8" (150mm - 200mm)	0.125 in. (3.2mm)
14" - 24" (350mm - 600mm)	0.188 in. (4.8mm)	10" - 12" (250mm - 300mm)	0.188 in. (4.8mm)

Dimensional Data

Size in. (mm)	A in. (mm)		B in. (mm)		C in. (mm)		D in. (mm)		Weight Lb. (kg.)			
	Flanged	Grooved	Flanged	Grooved	Flanged	Grooved	Flanged	Grooved	Cover		Unit	
End type	Flanged	Grooved	Flanged	Grooved	Flanged	Grooved	Flanged	Grooved	Flanged	Grooved	Flanged	Grooved
2" 50	10.81 275	-	8.25 210	-	13.25 337	-	1/2 15	-	5 2	-	28 13	-
2 1/2" 65	13.38 340	9.5 241	10.25 260	8.81 224	16.44 418	14.06 357	1 25	1/2 15	9 4	1 0.45	81 37	21 10
3" 80	13.38 340	9.63 244	10.25 260	9.25 235	16.44 418	14.75 375	1 25	1/2 15	9 4	1.2 0.54	81 37	26 12
4" 100	14.75 375	11.63 295	10.50 267	11.25 286	16.75 425	18.50 470	1 1/2 40	1/2 15	17 8	2.5 1.13	85 39	33 15
5" 125	17.25 438	15.13 384	12.50 318	13.25 337	20.00 508	21.00 533	1 1/2 40	1/2 15	20 9	4.6 2.08	110 50	46 21
6" 150	22.00 559	18.00 457	14.00 356	15.81 402	22.44 570	25.75 654	2 50	3/4 20	26 12	1.6 0.72	145 66	70 32
8" 200	24.00 610	21.13 537	17.75 451	19.63 499	28.44 722	32.31 821	2 50	3/4 20	45 20	3.1 6	256 116	91 41
10" 250	31.50 800	25.50 648	22.00 559	24.69 627	35.25 895	41.00 1041	2 50	3/4 20	70 32	4.6 2	380 172	134 61
12" 300	32.75 832	29.38 746	25.00 635	27.88 708	40.00 1016	47.00 1194	2 50	3/4 20	110 50	36 16	700 317	225 102
14" 350	39.75 1010	-	27.00 686	-	43.25 1099	-	2 50	-	140 63	-	750 340	-
16" 400	45.25 1149	-	30.88 784	-	49.50 1257	-	2 50	-	180 82	-	905 410	-
18" 450	48.50 1232	-	33.88 861	-	54.25 1378	-	2 50	-	220 100	-	1125 510	-
20" 500	53.75 1365	-	39.00 991	-	62.50 1588	-	2 50	-	285 129	-	1415 641	-
24" 600	64.00 1626	-	44.00 1118	-	70.50 1791	-	2 50	-	430 195	-	1825 827	-

Notes: 1. Dimensions shown are subject to change.



EXCELOK TECHNOLOGIES PTE LTD

No. 21, Bukit Batok Crescent #15-82 WCEGA Tower, Singapore-658 065.
Tel:+65-65671577 | sales@excelok.com.sg, www.excelok.com.sg



T150, T300 and T600 Tee Strainers

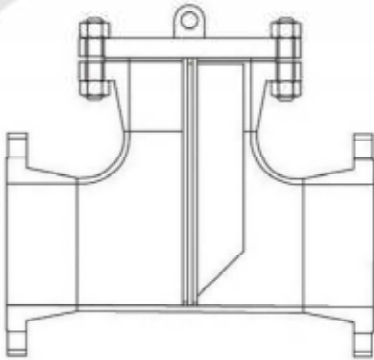

Design Features:

- Standard Sizes from 2" - 24". Larger sizes available upon request.
- Available with RF or RTJ flanged (ASME B16.5) or Buttweld (ASME B16.9) end connections.
- Standard thru bolt cover design.
- Three flow configurations are available.
- 304 SS perforated screens are standard.
- Upstream and downstream screen supports allow for bi-directional flow.
- May be installed in horizontal or vertical pipelines.
- Strainers designed to meet the requirements of ASME B31.1, ASME B31.3 and/or ASME Section VIII, Div. 1.
- Drains, vents, differentials and special covers are optional.

Parts List and Standard Materials

Part	Carbon Steel	Low Temp. Carbon Steel (-50°F)	Stainless Steel ¹
Body	A234-WPB	A420-WPL6	A403-WP
Flanges	A105	A350-LF2	A182
Screen ¹	304 SS	304 SS	304 SS
Internal support ribs:	Carbon Steel	304 SS	304 SS
Coupling/threadolets	A105	A350-LF2	A182
Plug	A105	A350-LF2	A182
Gasket ¹	304 SS Spiral Wound	304 SS Spiral Wound	304 SS Spiral Wound
Stud	A193-B7	A193-B7	A193-B8-1
Nut	A194-2H	A194-2H	A194-8

Notes: 1. Recommended Spares.

Upper Pressure Limits (Non-Shock) and lower temperature Limits (Unless otherwise specified)

(RF Flanged)	Body Material	Maximum Design Pressure— at 100°F — psig (Bars)	Lower Temperature Limit — M.D.M.T. — °F (°C)
T150	Carbon Steel	285 (19.65)	-20 (-28.9)
	Low Temp. Carbon Steel	285 (19.65)	-50 (-45.6)
	304 / 316 SS	275 (18.96)	-20 (-28.9) Optional -425 (-253.9)
	304L / 316L SS	230 (15.86)	-20 (-28.9) Optional -425 (-253.9)
T300	Carbon Steel	740 (51.02)	-20 (-28.9)
	Low Temp. Carbon Steel	740 (51.02)	-50 (-45.6)
	304 / 316 SS	720 (49.64)	-20 (-28.9) Optional -425 (-253.9)
	304L / 316L SS	600 (41.37)	-20 (-28.9) Optional -425 (-253.9)
T600	Carbon Steel	1480 (102.04)	-20 (-28.9)
	Low Temp. Carbon Steel	1480 (102.04)	-50 (-45.6)
	304 / 316 SS	1440 (99.28)	-20 (-28.9) Optional -425 (-253.9)
	304L / 316L SS	1200 (82.74)	-20 (-28.9) Optional -425 (-253.9)



EXCELOK TECHNOLOGIES PTE LTD

No. 21, Bukit Batok Crescent #15-82 WCEGA Tower, Singapore-658 065.
Tel:+65-65671577 | sales@excelok.com.sg, www.excelok.com.sg



TI50 Dimensional Data

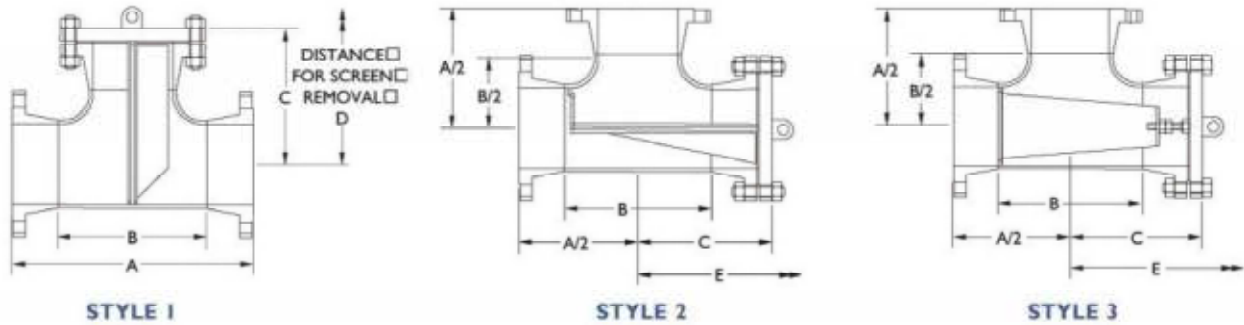

Standard Screens

Size Range	Opening	Gauge Thickness
2" - 8" (50mm - 200mm)	0.125 in. (3.2mm)	22
10" - 12" (250mm - 300mm)	0.125 in. (3.2mm)	16
14" - 24" (350mm - 600mm)	0.188 in. (4.8mm)	11

Dimensional Data

Size in. (mm)	A in. (mm)	B in. (mm)	C in. (mm)	D in. (mm)	E in. (mm)	Weight Lb. (kg.)		
						Cover	Unit Flanged	Buttweld
2"	10.00	5.00	5.75	11.00	12.50	5	28	16
50	254	127	146	279	318	2	13	7
3"	12.25	6.75	7.06	13.75	15.25	9	52	32
80	311	172	179	349	387	4	24	15
4"	14.25	8.25	8.06	16.25	18.38	17	79	49
100	362	210	205	413	467	8	36	22
5"	16.75	9.75	9.31	19.25	21.63	20	105	67
125	425	248	237	489	549	9	8	30
6"	18.25	11.25	10.13	21.25	23.68	26	140	92
150	464	286	257	540	606	12	64	42
8"	22.00	14.00	12.13	26.00	29.00	45	230	152
200	559	356	308	660	737	20	104	69
10"	25.00	17.00	13.69	30.00	33.50	70	325	221
250	635	432	348	762	851	32	148	100
12"	29.00	20.00	15.75	35.00	39.00	110	500	340
300	737	508	400	889	991	50	227	154
14"	32.00	22.00	17.38	39.00	43.00	140	710	490
350	813	559	441	991	1092	64	322	222
16"	34.00	24.00	18.44	42.00	46.00	180	860	580
400	864	610	468	1067	1168	82	390	263
18"	38.00	27.00	20.56	47.00	51.50	220	1025	725
450	965	686	522	1194	1308	100	465	329
20"	41.36	30.00	22.38	51.38	56.38	285	1350	990
500	1051	762	568	1305	1432	129	613	449
24"	46.00	34.00	24.88	58.00	63.00	430	2100	1580
600	1168	864	632	1473	1600	195	953	717



EXCELOK TECHNOLOGIES PTE LTD

No. 21, Bukit Batok Crescent #15-82 WCEGA Tower, Singapore-658 065.

Tel:+65-65671577 | sales@excelok.com.sg, www.excelok.com.sg



T300 Dimensional Data

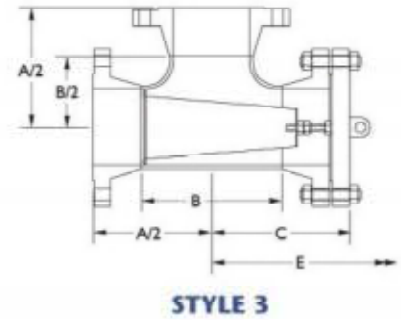
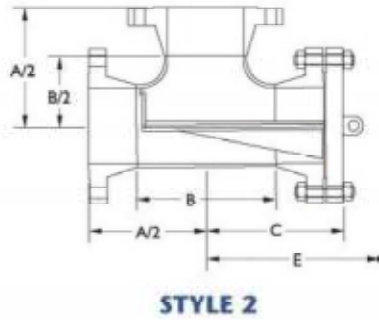
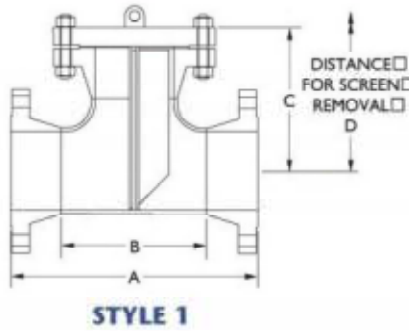

Standard Screens

Size Range	Opening	Gauge Thickness
2" - 8" (50mm - 200mm)	0.125 in. (3.2mm)	22
10" - 12" (250mm - 300mm)	0.125 in. (3.2mm)	16
14" - 24" (350mm - 600mm)	0.188 in. (4.8mm)	11

Dimensional Data

Size in. (mm)	A in. (mm)	B in. (mm)	C in. (mm)	D in. (mm)	E in. (mm)	Weight Lb. (kg.) Unit		
						Cover	Flanged	Buttweld
2"	10.50	5.00	6.13	11.50	13.00	8	42	24
50	267	127	156	292	330	4	19	11
3"	13.00	6.75	7.63	14.50	16.00	16	72	42
80	330	172	194	368	406	7	33	19
4"	15.00	8.25	8.75	17.00	19.13	27	125	75
100	381	210	222	432	486	12	57	34
5"	17.50	9.75	10.13	20.00	22.38	35	160	96
125	445	248	257	508	568	16	73	44
6"	19.00	11.25	10.94	22.00	24.63	50	225	141
150	483	286	278	559	625	23	102	62
8"	22.75	14.00	13.00	26.75	29.75	81	350	216
200	578	356	330	679	756	37	159	98
10"	26.25	17.00	15.00	31.25	34.75	124	495	313
250	667	432	381	794	883	56	225	142
12"	30.25	20.00	17.13	36.25	40.25	185	765	485
300	768	508	435	921	1022	84	347	220
14"	33.25	22.00	18.75	40.25	44.25	250	1025	665
350	845	559	476	1022	1124	114	465	302
16"	35.50	24.00	20.00	43.50	47.50	295	1320	820
400	902	610	508	1105	1207	134	599	372
18"	39.50	27.00	22.13	48.50	53.00	395	1700	1060
450	1003	686	562	1232	1346	179	772	481
20"	32.75	30.00	23.88	42.75	47.75	505	2250	1450
500	832	762	606	1086	1213	229	1022	658
24"	47.25	34.00	26.38	59.25	64.25	790	2340	2240
600	1200	864	670	1505	1632	359	1544	1017



EXCELOK TECHNOLOGIES PTE LTD

No. 21, Bukit Batok Crescent #15-82 WCEGA Tower, Singapore-658 065.
Tel:+65-65671577 | sales@excelok.com.sg, www.excelok.com.sg



T600 Dimensional Data

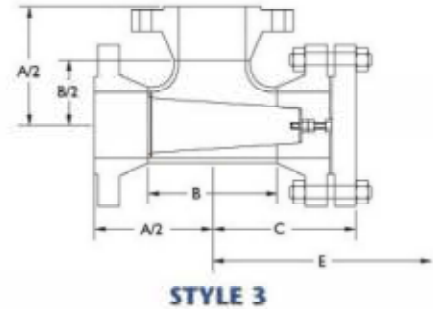
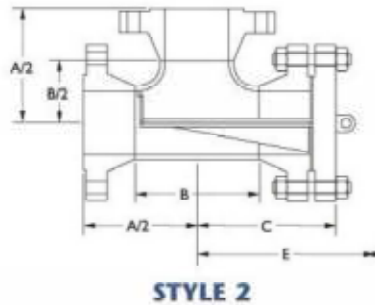
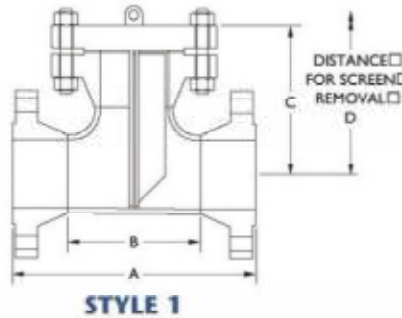

Standard Screens

Size Range	Opening	Gauge Thickness
2" - 8" (50mm - 200mm)	0.125 in. (3.2mm)	22
10" - 12" (250mm - 300mm)	0.125 in. (3.2mm)	16
14" - 24" (350mm - 600mm)	0.188 in. (4.8mm)	11

Dimensional Data

Size in. (mm)	A in. (mm)	B in. (mm)	C in. (mm)	D in. (mm)	E in. (mm)	Weight Lb. (kg.) Unit		
						Cover	Flanged	Buttweld
2"	11.25	5.00	6.88	12.25	13.75	10	52	28
50	286	127	175	311	349	5	24	13
3"	13.75	6.75	8.38	15.25	16.75	20	100	54
80	349	172	213	387	425	9	45	25
4"	16.75	8.25	10.13	18.75	20.88	41	190	106
100	425	210	257	476	530	19	86	48
5"	19.25	9.75	11.63	21.75	24.13	68	295	159
125	489	248	295	552	613	31	134	72
6"	21.00	11.25	12.63	24.00	25.63	86	365	203
150	533	286	321	610	676	39	166	92
8"	25.00	14.00	14.94	29.00	32.00	140	580	340
200	635	356	379	737	813	64	263	154
10"	29.50	17.00	17.50	34.50	38.00	230	900	520
250	749	432	445	876	965	104	409	236
12"	32.75	20.00	19.25	38.75	42.75	295	1150	700
300	832	508	489	984	1086	134	522	318
14"	35.50	22.00	20.75	42.50	46.50	355	1480	920
350	902	559	527	1080	1181	161	672	418
16"	38.50	24.00	22.50	46.50	50.50	495	1950	1170
400	978	610	572	1181	1283	225	885	531
18"	42.00	27.00	24.50	51.00	55.50	630	2450	1500
450	1067	686	622	1295	1410	286	1112	681
20"	45.50	30.00	26.50	55.50	60.50	810	3150	1970
500	1156	762	673	1410	1537	368	1430	894
24"	50.50	34.00	29.50	62.50	67.50	1250	4600	2940
600	1283	864	749	1588	1715	568	2088	1335



EXCELOK TECHNOLOGIES PTE LTD

No. 21, Bukit Batok Crescent #15-82 WCEGA Tower, Singapore-658 065.

Tel:+65-65671577 | sales@excelok.com.sg, www.excelok.com.sg



Instrumentation
Products



EXCELOK TECHNOLOGIES PTE LTD

No. 21, Bukit Batok Crescent #15-82 WCEGA Tower, Singapore-658 065.
Tel:+65-65671577 | sales@excelok.com.sg, www.excelok.com.sg

